

## T900 VARAAVA TAKKA

Peruskokoinen PT tiili	~67 kpl
UT-tiili 257x85x57	~149kpl
MRT 60 kuorimuuraukseen	~197kpl
TTT tulitiili,257/123/57	~18 kpl
MTT tulitiili,257/85/57	~77kpl
Saviuunilaasti	~216 kg
Tulenkestävä valumassa	~100 kg
M100/600, muurauslaasti kuoreen	~177 kg
Tulenkestävä muurauslaasti ,tulitiilien muuraukseen	~25kg
TUL 10, tulisijalevy	~4,788m <sup>2</sup>
PAL50, palonsuojalevy	1 levy
Takkaluukku 275/335	1
Tuhkapesän luukku 270/130, muurausholkkeineen	1
Nuohousluukku 130/130,muurausholkkeineen	2

VARAAVA TAKKA 900

A-A

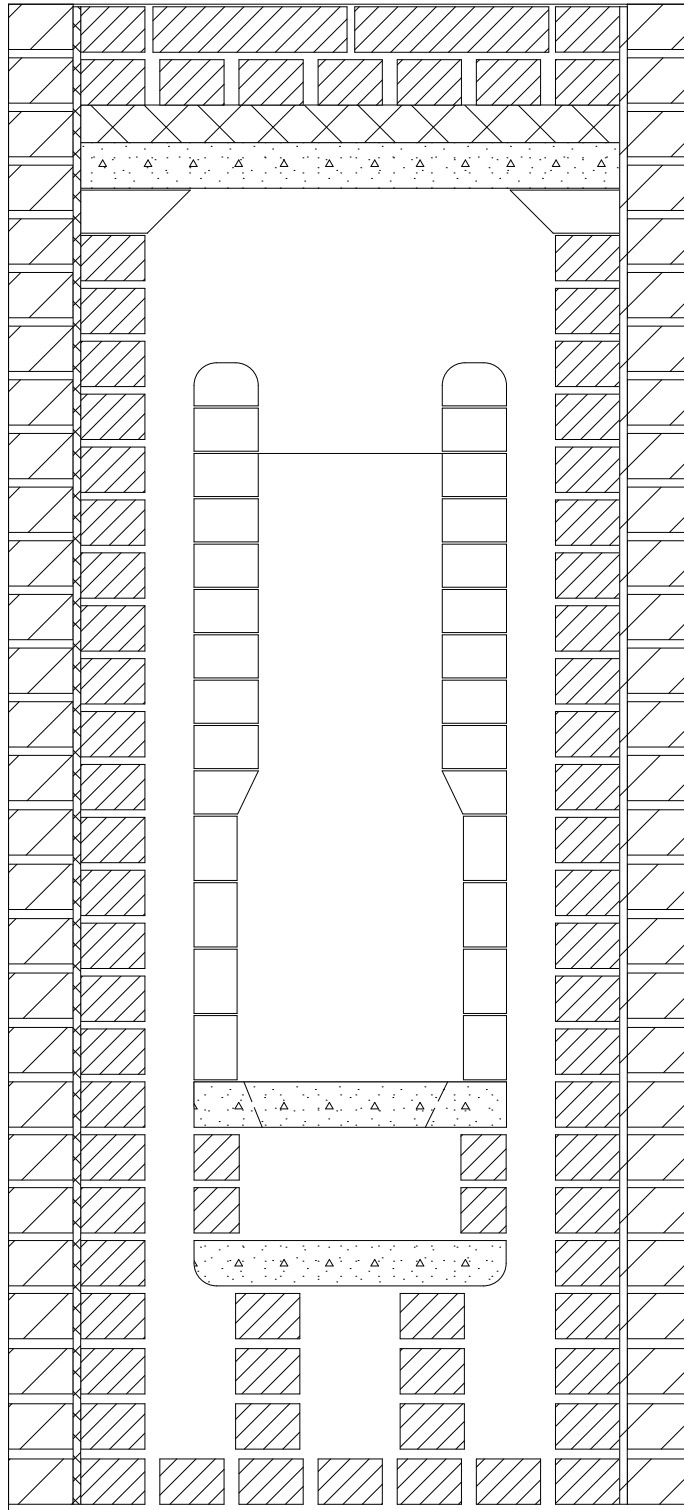

1 995

# VARAAVA TAKKA 900

## B-B

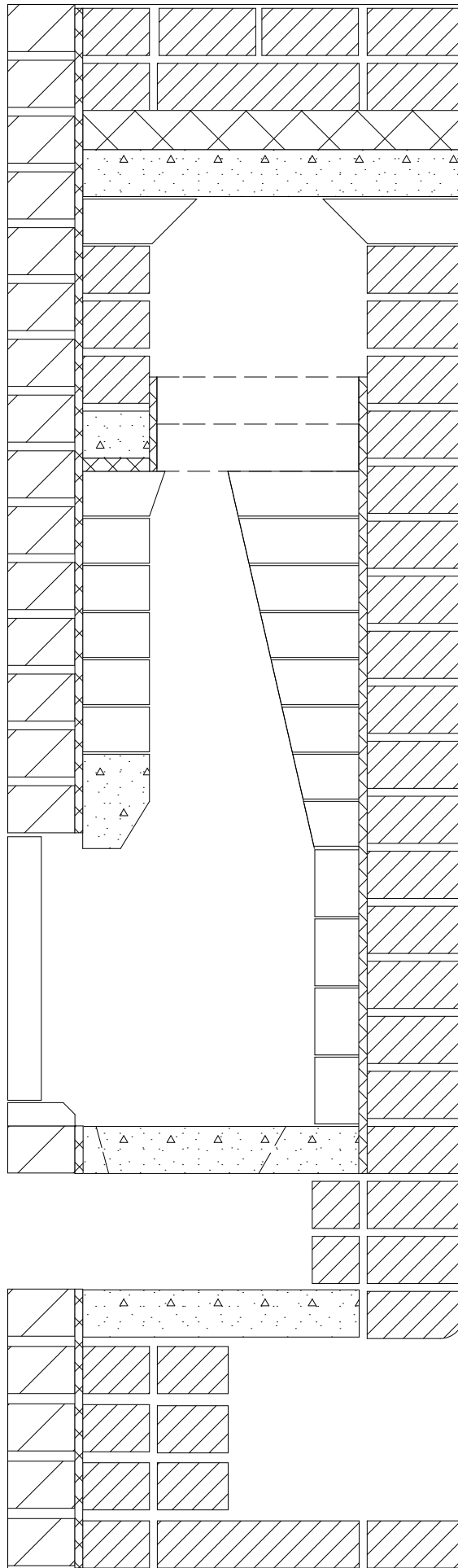

# VARAAVA TAKKA 900

EDESTÄ

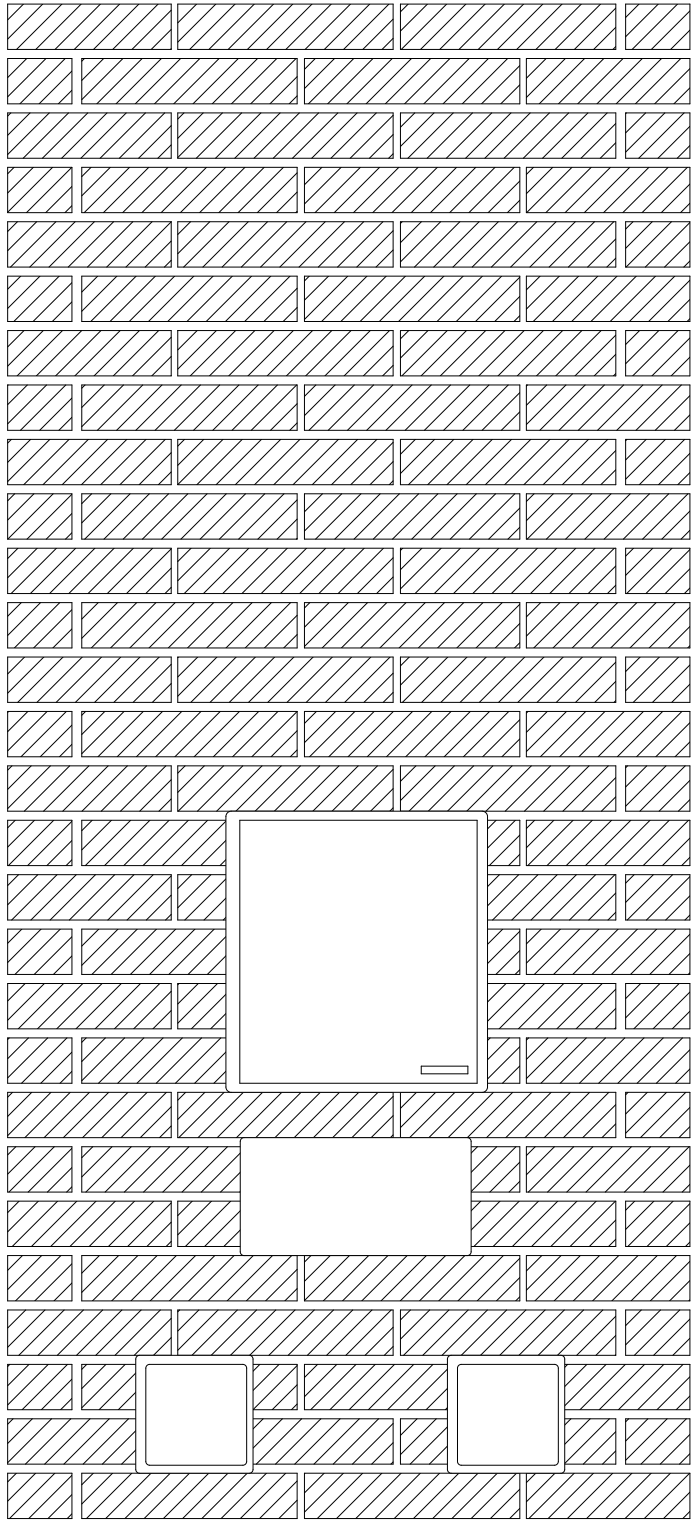

SIVULTA

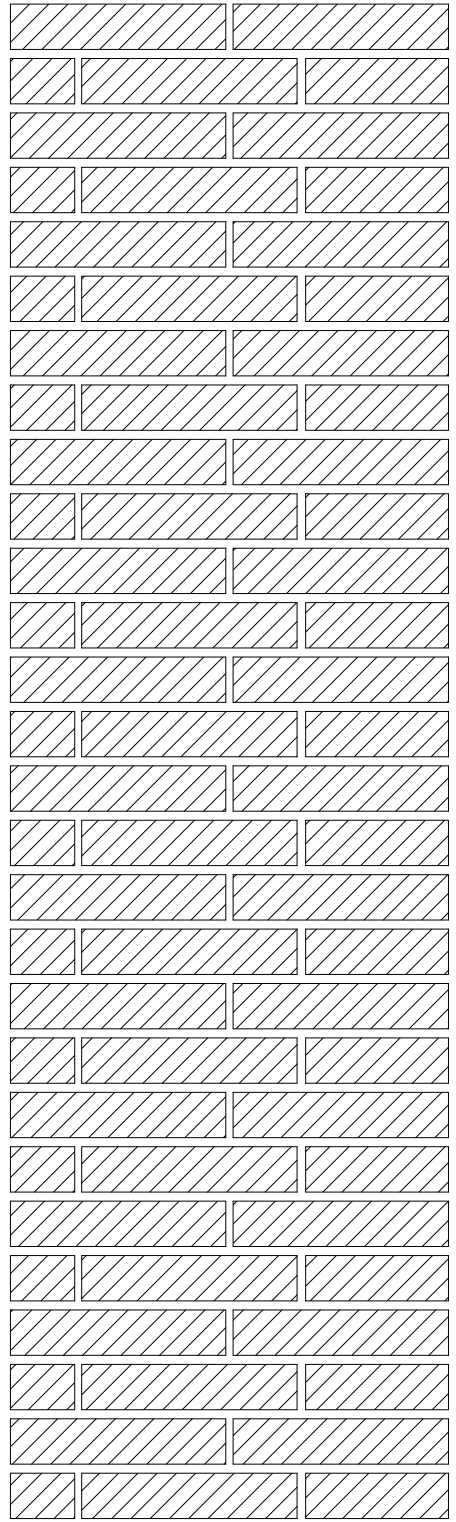

VARAAVA TAKKA 900

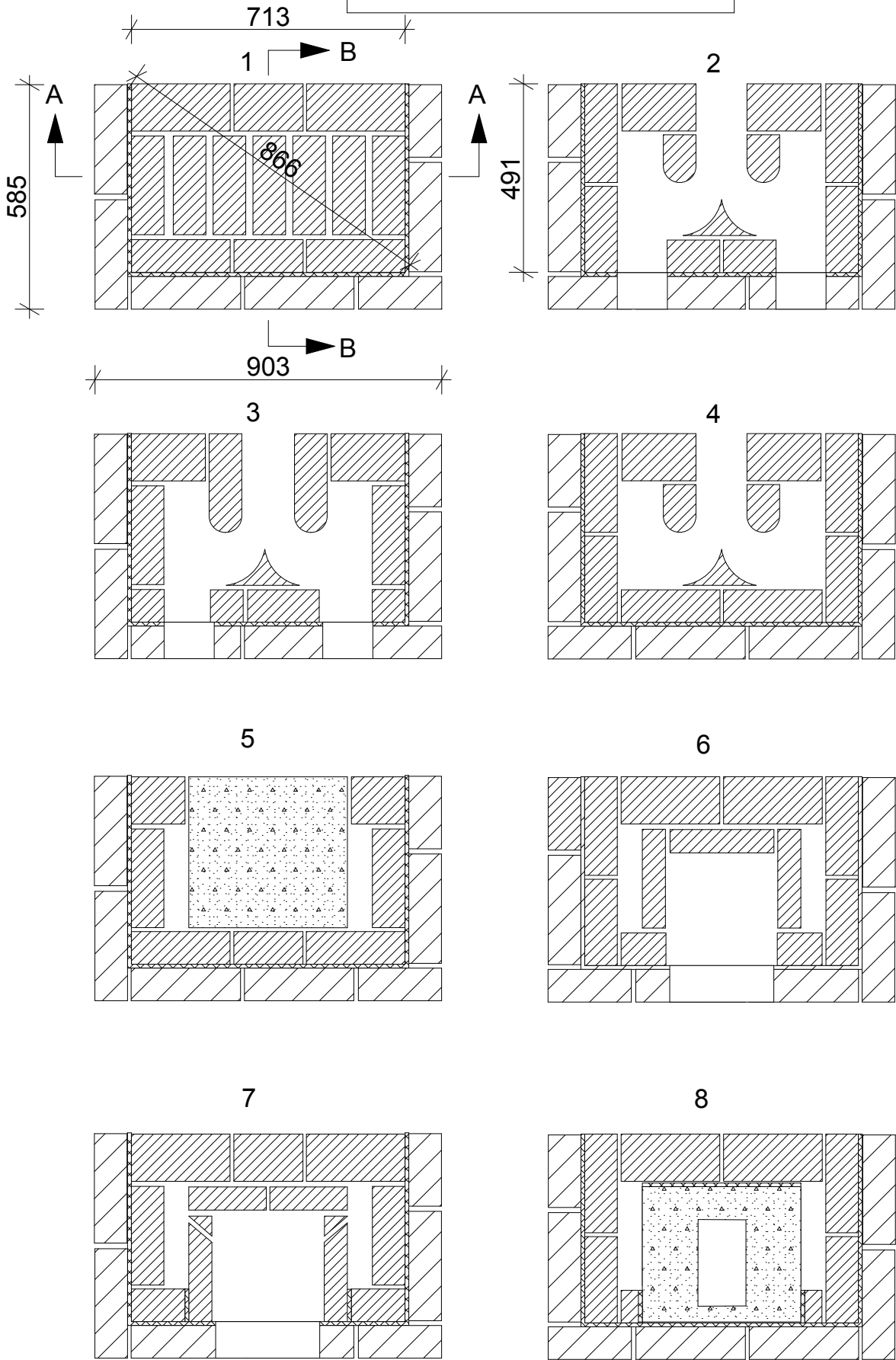

9

VARAAVA TAKKA 900

10

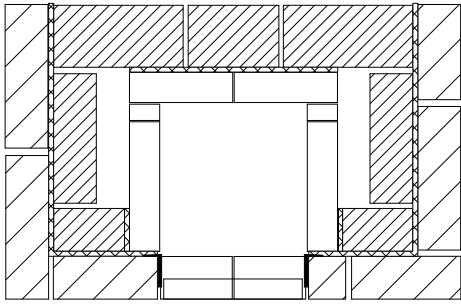

11

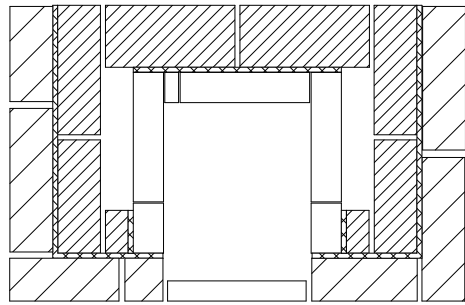

12

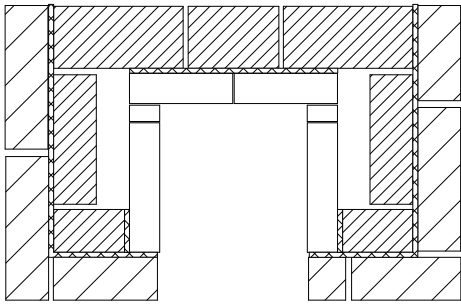

13

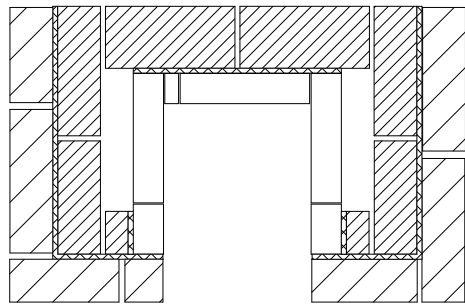

14

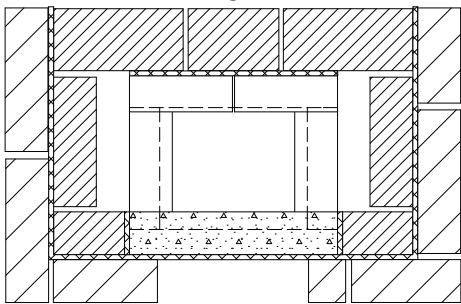

15

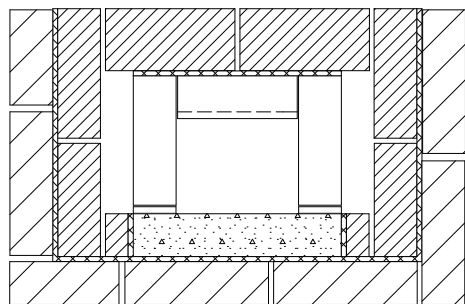

16

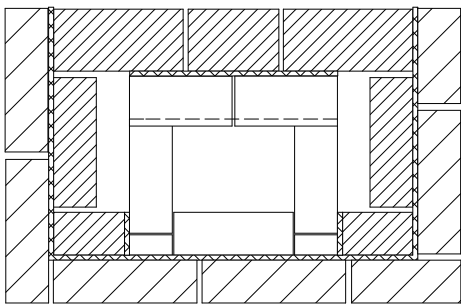

17

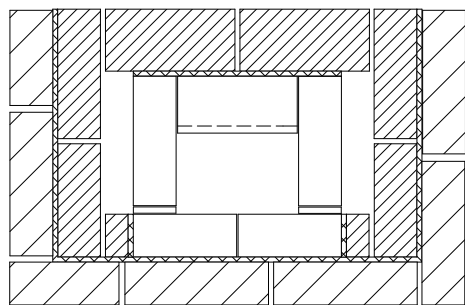

18

# VARAAVA TAKKA 900

19

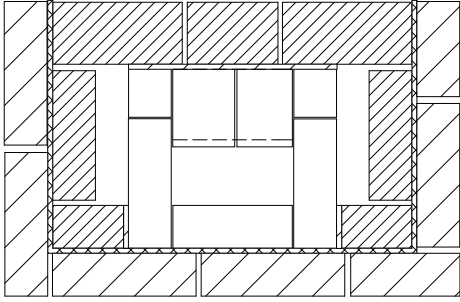

20

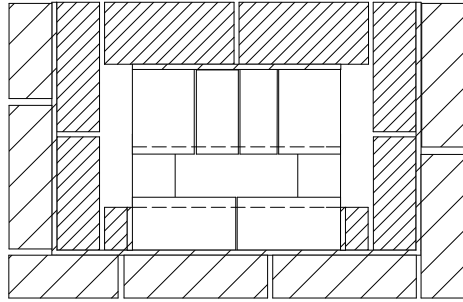

21

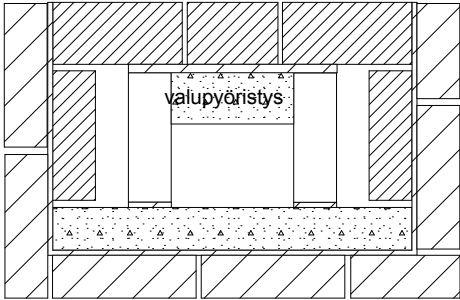

22

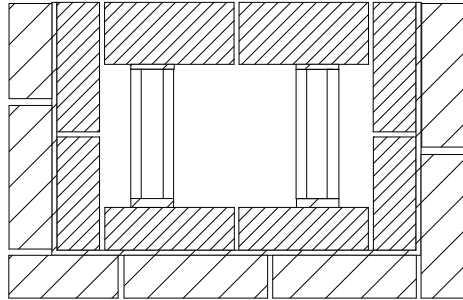

23

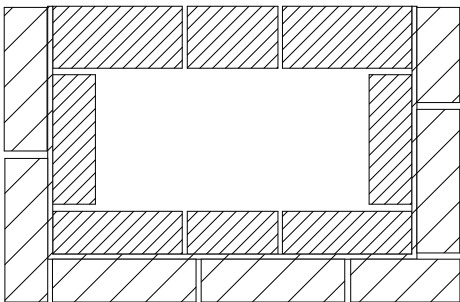

24

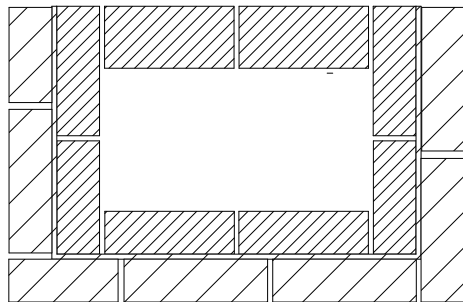

25

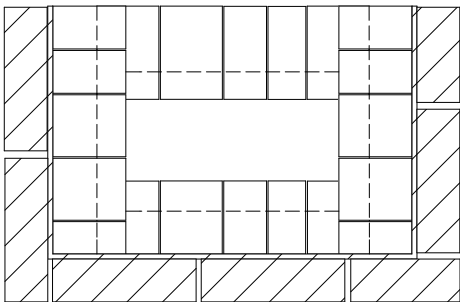

26

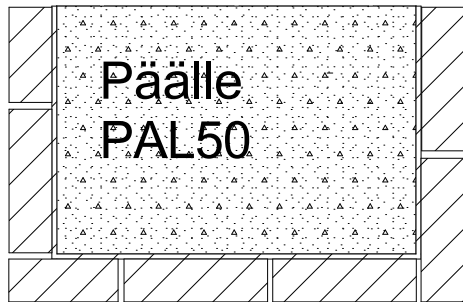

27

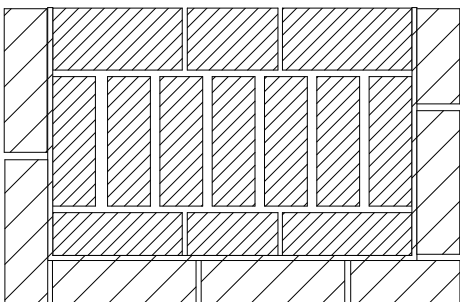

28

