

VARAAVA KULMATAKKA 1200

Peruskokoinen PT tiili	~213kpl
UT-tiili 257/85/57	~103kpl
MRT 60 kuorimuuraukseen	~119 kpl
MTT tulitiili,257/85/57	~63kpl
Saviuunilaasti	~316 kg
Tulenkestävä valumassa	~160 kg
M100/600 , kuoreen	~216 kg
Tulenkestävä muurauslaasti,tulitiilien muuraukseen	~50kg
TUL 10, tulisijalevy	~7,266m ²
PAL50, palonsuojalevy	1 levy
Takkaluukku 410/410	1
Tuhkapesän luukku 270/130, muurausholkkeineen	1
Nuohous 130/130, holkkeineen	2
Lattateräs 6/60 L=300mm	1

VARAAVA KULMATAKKA 1200

A-A

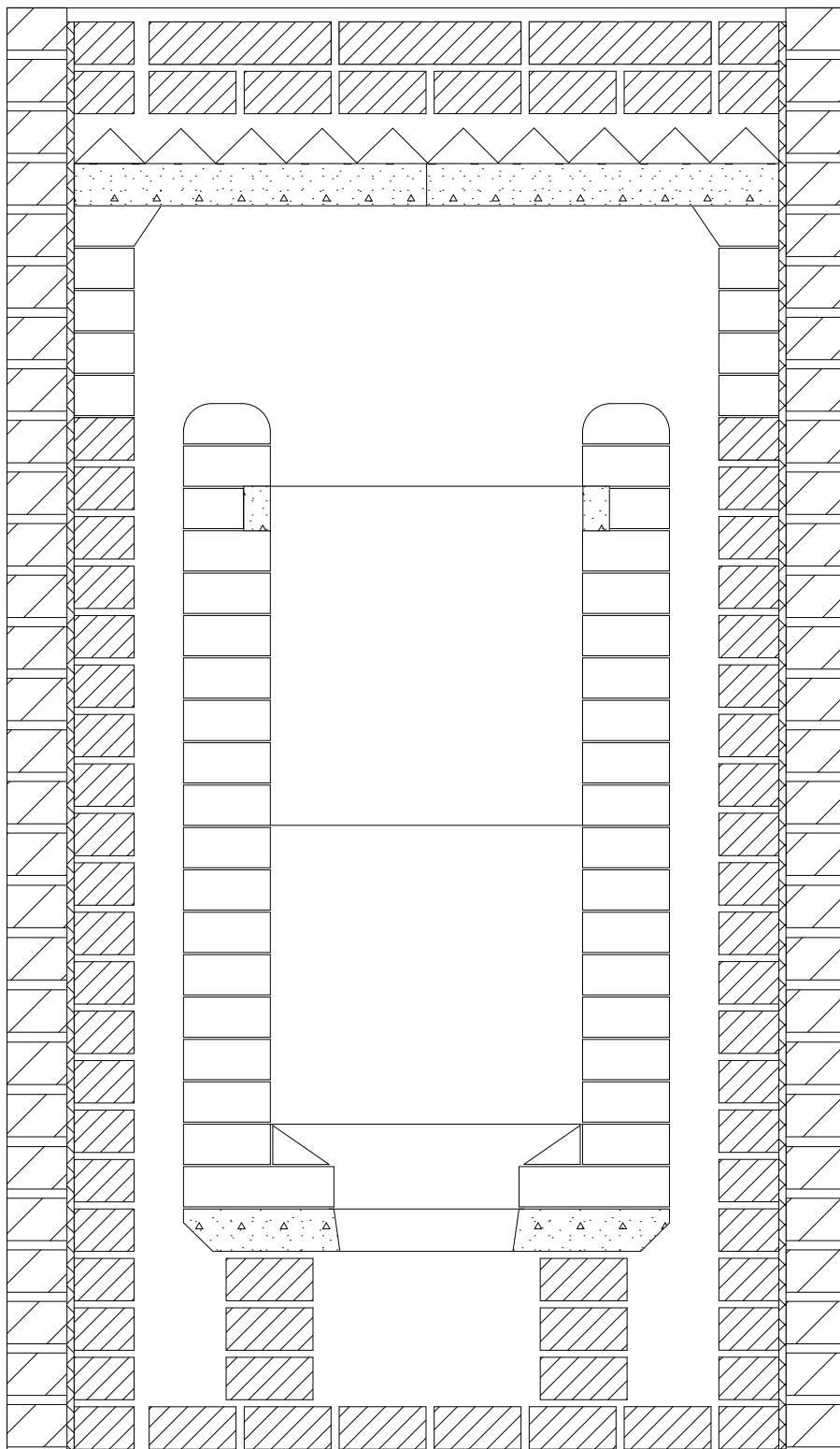

2045

VARAAVA KULMATAKKA 1200

B-B

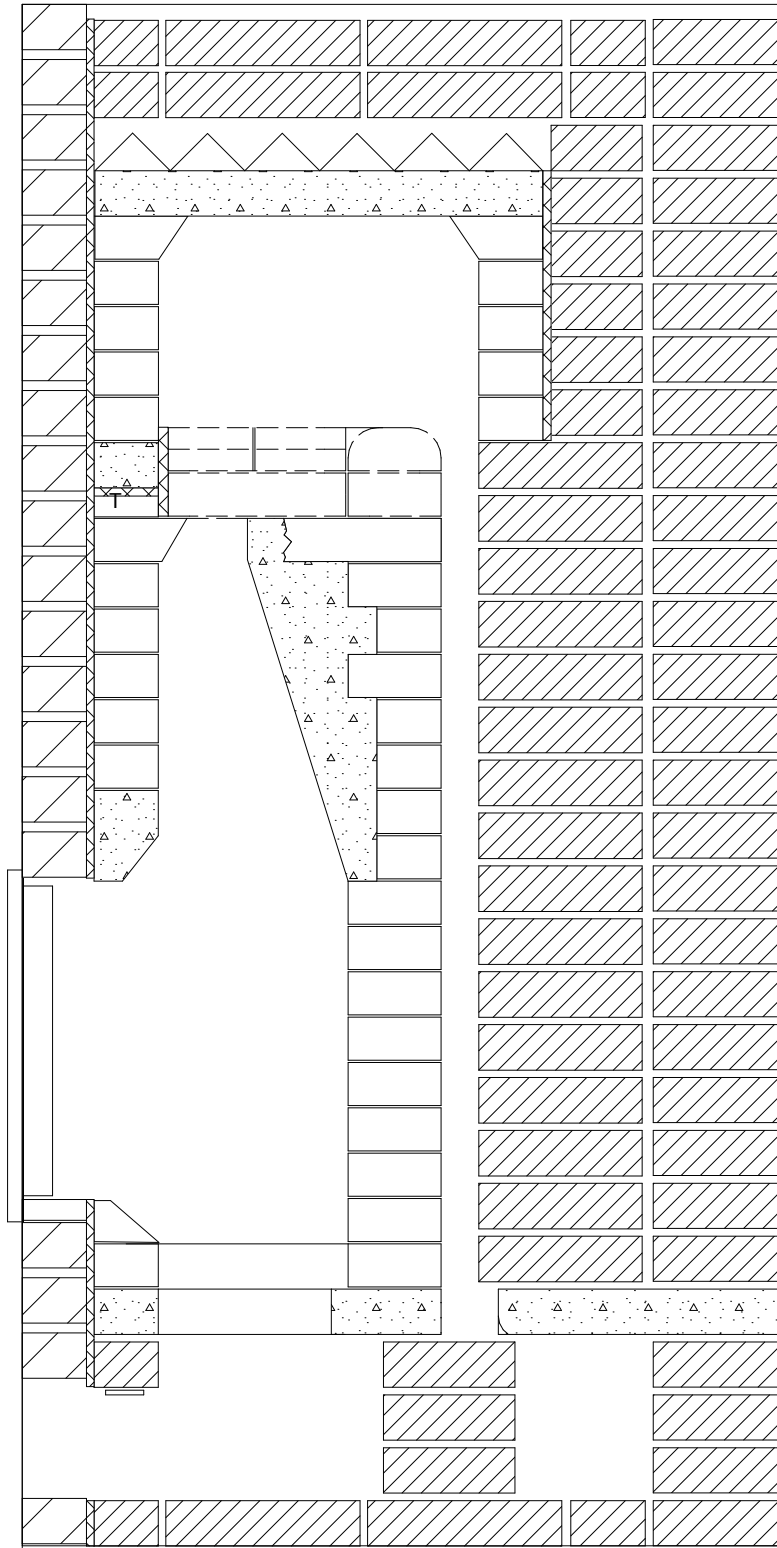

VARAAVA KULMATAKKA 1200

Edestä

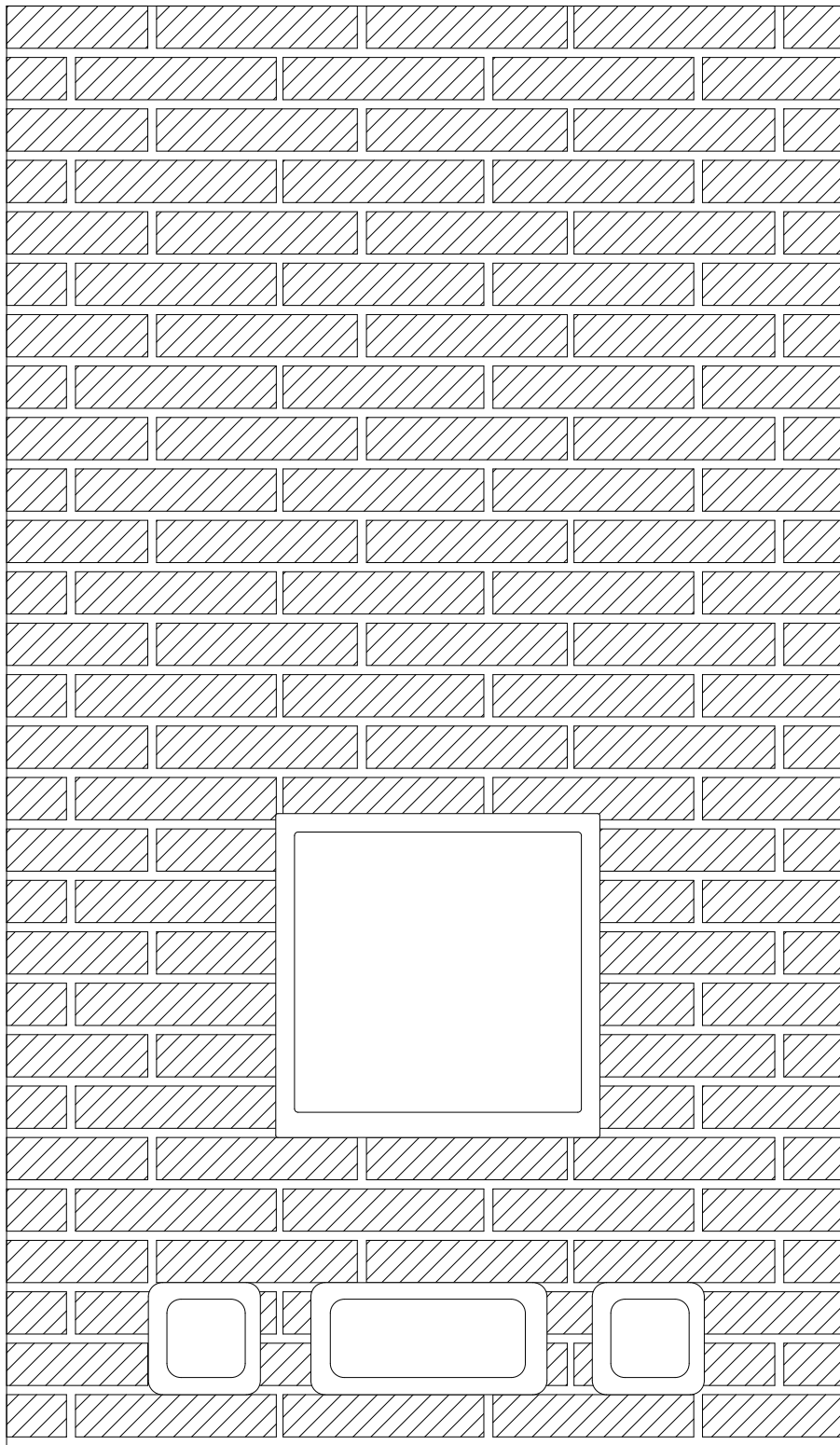

VARAAVA KULMATAKKA 1200

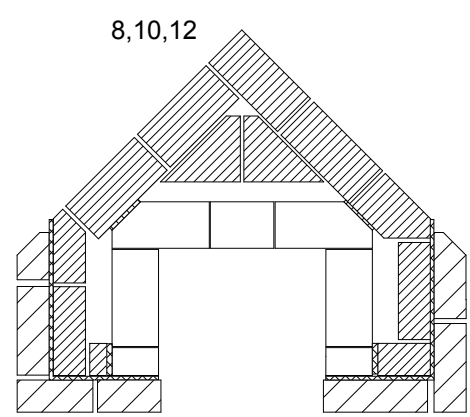
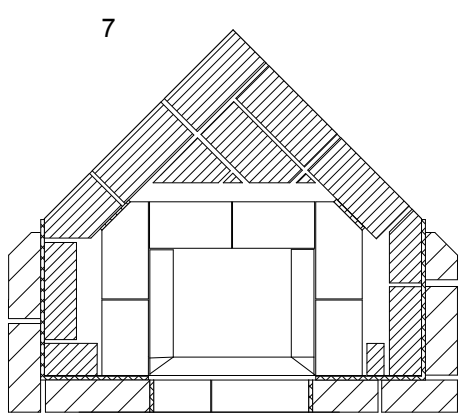
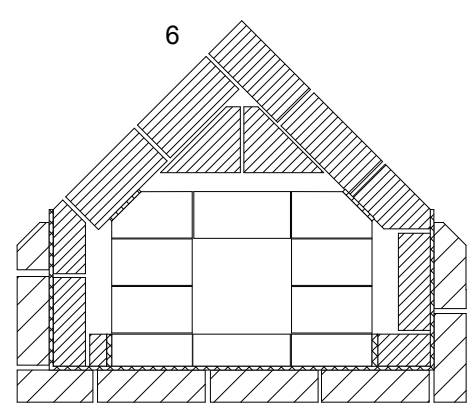
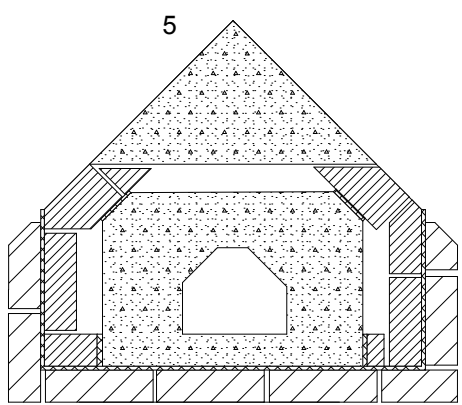
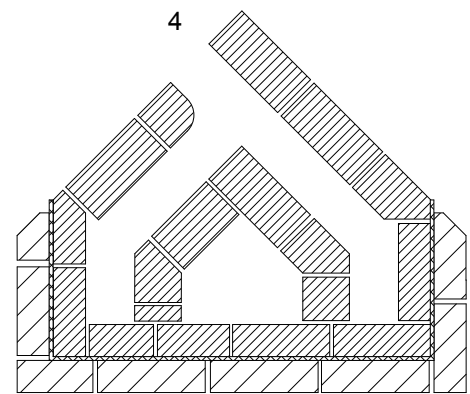
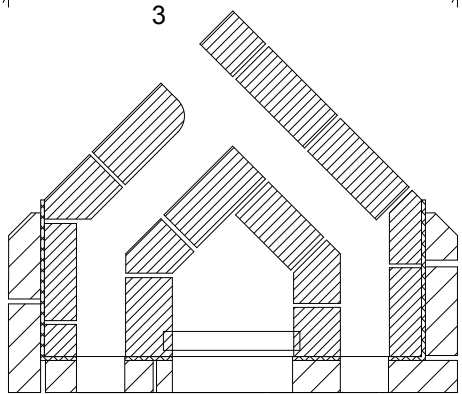
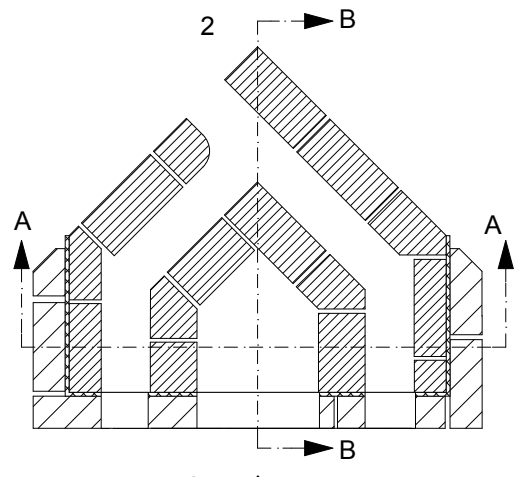
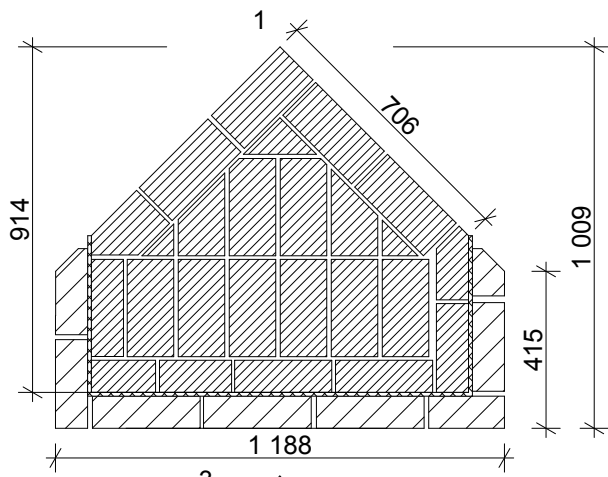

VARAAVA KULMATAKKA 1200

9,11,13

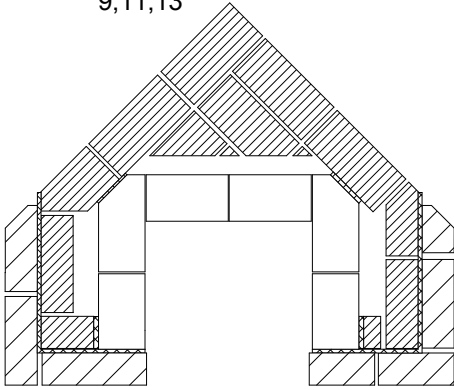

12.5

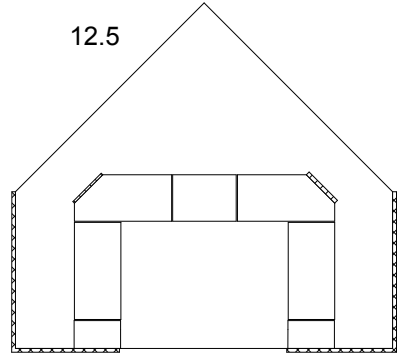

13.5

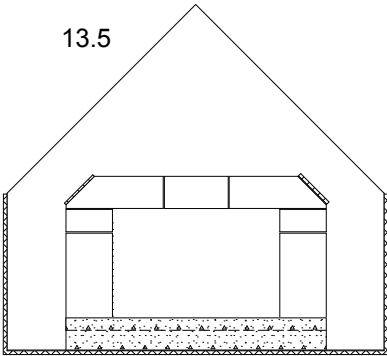

14

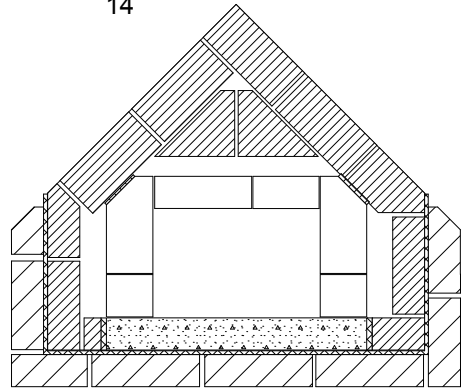

15

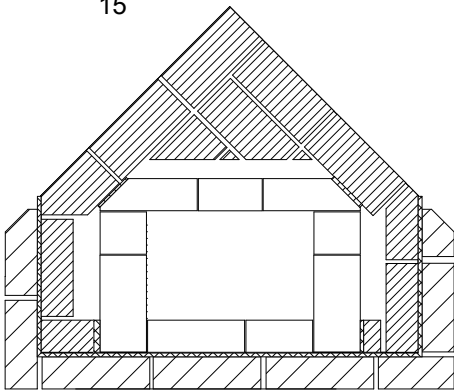

16

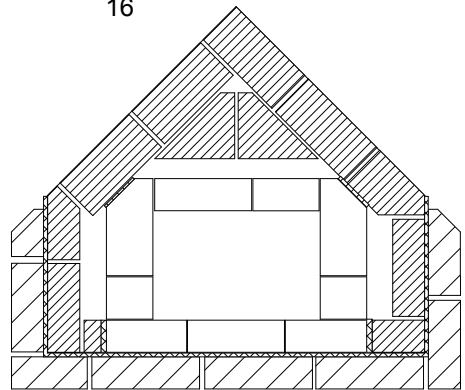

17

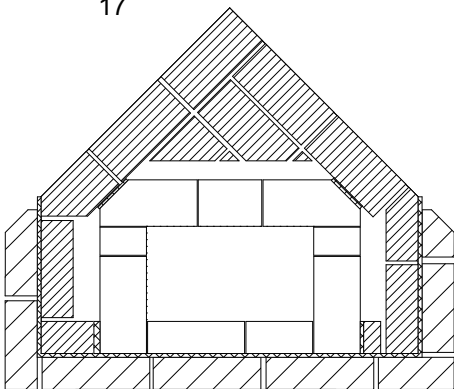

18

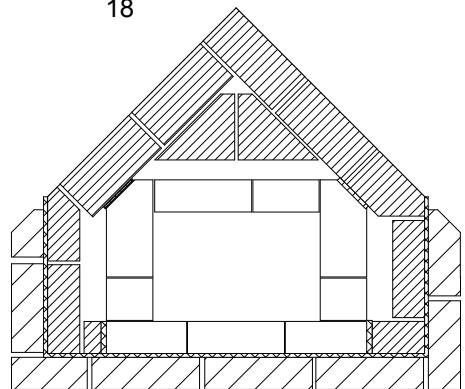

VARAAVA KULMATAKKA 1200

18.5

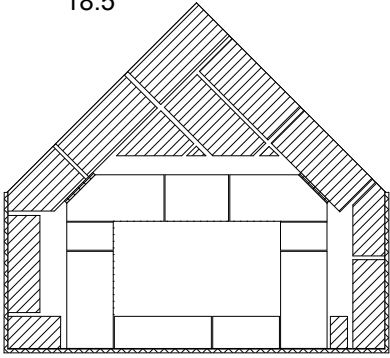

19

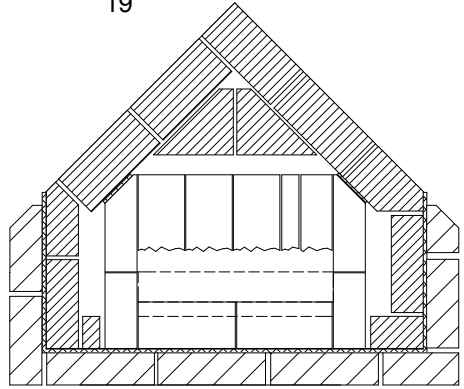

20

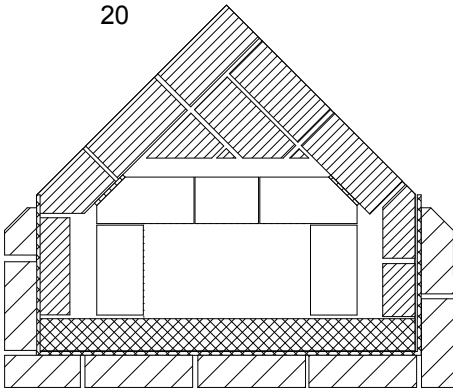

21

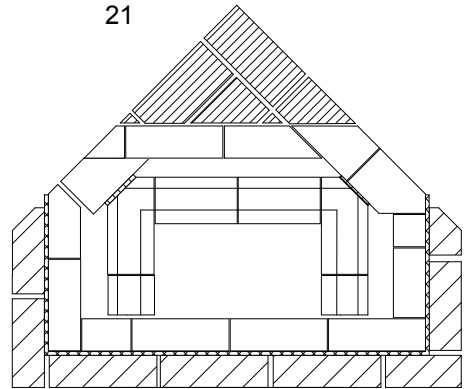

22,24

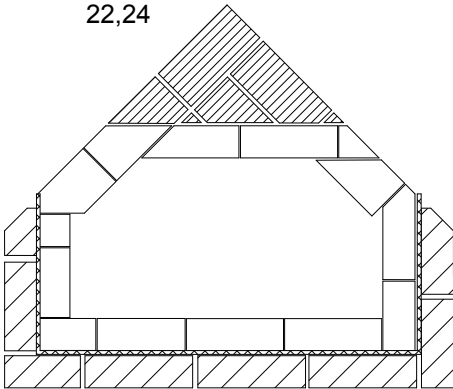

23

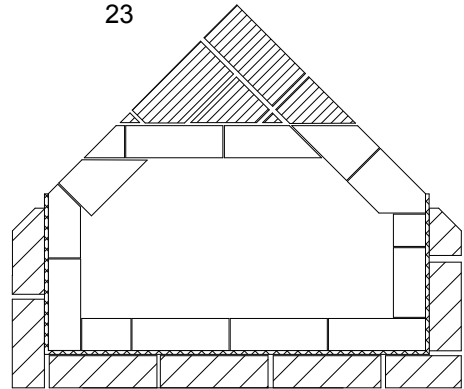

25

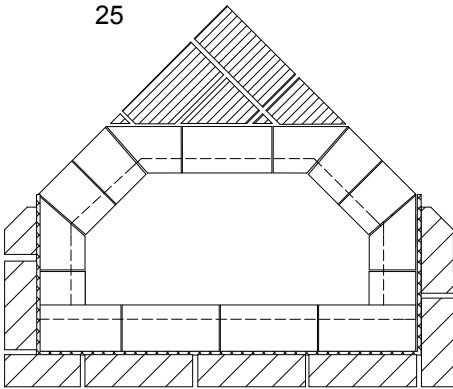

26

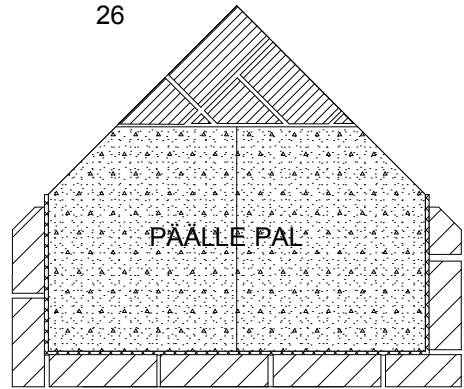

VARAAVA KULMATAKKA 1200

27

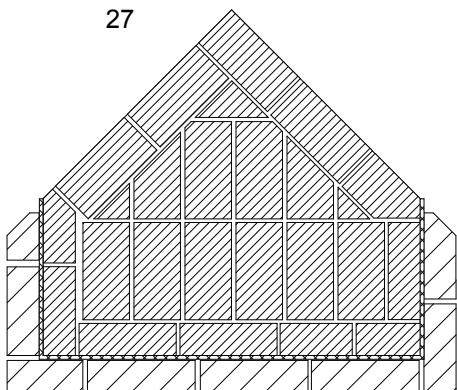

28

